

OACIS

Open Architecture Control Integrated System

LoadCell Amp Installation SGA

Version 01.09



www.atainc.com

ata@atainc.com

All Rights Reserved

CONTENTS

| | |
|---|----------|
| I. DIMENSION | 3 |
| II. J1 SETTING | 3 |
| A. Output & Power In Connections | 3 |
| III. J2 SETTING | 4 |
| A. Input Sensor Connections..... | 4 |
| B. Grounding J2 Terminal | 4 |
| IV. JP3 SETTING..... | 4 |
| A. 800Hz Input Filter | 4 |
| V. SW1 SETTING | 5 |
| A. Gain Sensitivity mV/V | 5 |
| VI. SW3 SETTING | 5 |
| A. Output Filter..... | 5 |
| VII. SW4 SETTING | 5 |
| A. Output Connections..... | 5 |
| VIII. CABLE CONNECTIONS..... | 5 |
| REVISION | 6 |

I. DIMENSION

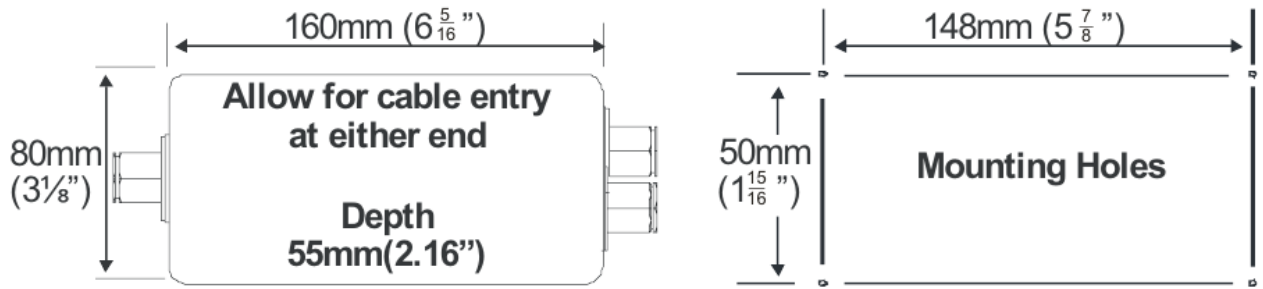

II. J1 SETTING

A. Output & Power In Connections

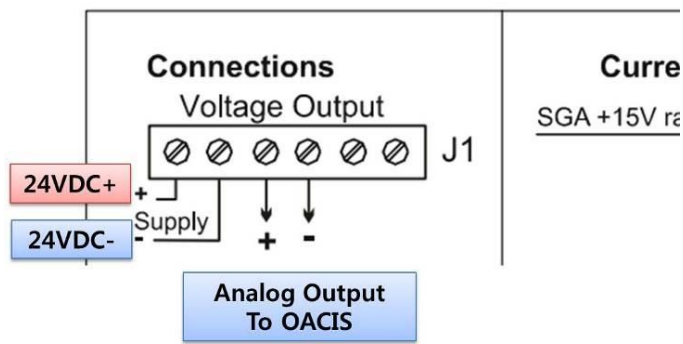

MISC

III. J2 SETTING

A. Input Sensor Connections

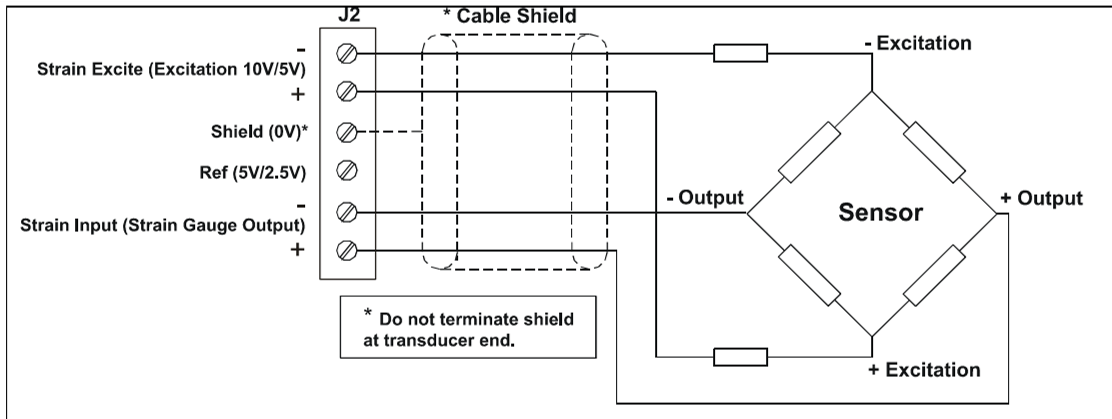

B. Grounding J2 Terminal

****IMPORTANT: OACIS Chassis Ground should be connected to the "Shield Terminal".**

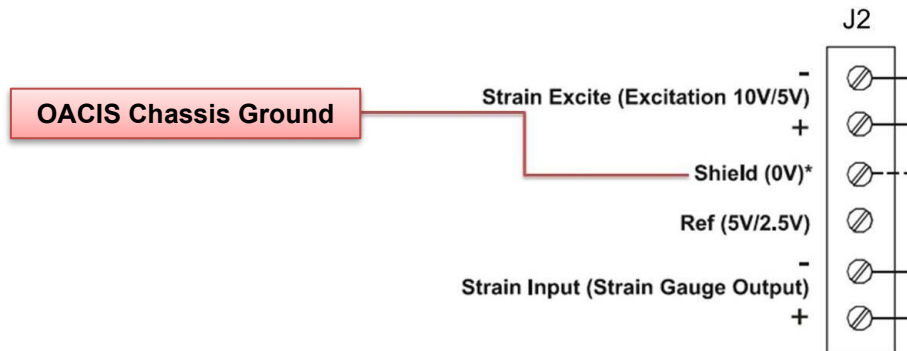

IV. JP3 SETTING

A. 800Hz Input Filter

****JP3 needs to be set as shown in the red circle to enable "800Hz Input Filter"**

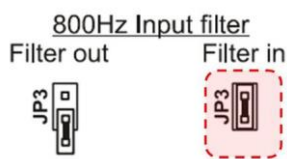

V. SW1 SETTING

A. Gain Sensitivity mV/V

** Consult ATA and See the manual

VI. SW3 SETTING

A. Output Filter

**Set as "100Hz" as shown below

| SW3 | 1 | 2 | 3 | 4 | 5 | 6 | 7 | 8 |
|-------|--------|--------|--------|--------|--------|--------|--------|--------|
| 1Hz | 0 ↓ | 0 ↓ | 0 ↓ | 0 ↓ | 0 ↓ | 0 ↓ | 1 ↑ | 1 ↑ |
| 5Hz | 1 ↑ | 0 ↓ | 0 ↓ | 0 ↓ | 0 ↓ | 1 ↑ | 1 ↑ | 1 ↑ |
| 10Hz | 1 ↑ | 1 ↑ | 0 ↓ | 0 ↓ | 1 ↑ | 1 ↑ | 1 ↑ | 1 ↑ |
| 50Hz | 1 ↑ | 1 ↑ | 1 ↑ | 1 ↑ | 1 ↑ | 1 ↑ | 1 ↑ | 1 ↑ |
| 100Hz | 0 ↓ | 0 ↓ | 0 ↓ | 0 ↓ | 0 ↓ | 0 ↓ | 0 ↓ | 0 ↓ |

VII. SW4 SETTING

A. Output Connections

**Switch settings : 0 = Off / 1 = On / X = Don't Care

Table 3.2 Switch 4

| Analogue Output and Excitation Voltage Options - SW4 | | | | | | | | | |
|--|----|----|----|---|---|----|-----|----------------------|--|
| SW4 | 1 | 2 | 3 | 4 | 5 | 6 | 7 | 8 | |
| ±10V | 0↓ | 0↓ | 0↓ | X | X | ON | OFF | 1↑=10V Exc 0↓=5V Exc | |
| | | | | | | | | ON | |

VIII. CABLE CONNECTIONS

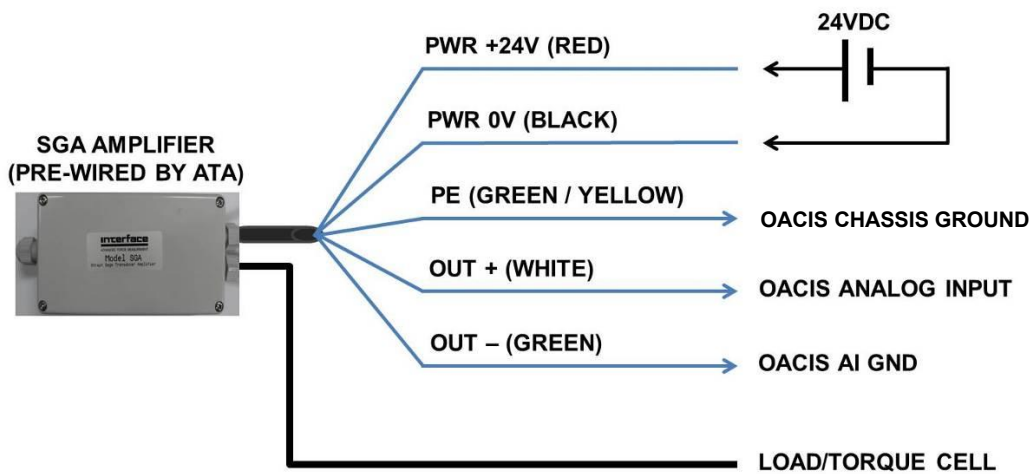

MISC

REVISION

v1.00: Engineering Released

v1.01: VII. Cable Connections Added

v1.02: Document Format Updated

v1.03:

- "Headers & Footers" Format Updated
- V. SW3 Setting Revised

v1.04:

- Image Size & Resolution Updated
- V. SW3 Setting Revised

v1.05: All Contents Downsized

v1.06: Revised ground name in II-B, VII

v1.07: Page Format Updated

v1.08: Dimension Added

v1.09: Manual name Updated